



Manual

1. Main Window

- 1.1 1. Preview
- 1.2 2. Color Values
- 1.3 3. Color Palette
- 1.4 4. Clear All Colors
- 1.5 5. Pick Color
- 1.6 6. Current Shortcut
- 1.7 7. Settings

2. Settings

- 2.1 1. Language
- 2.2 2. Shortcut
- 2.3 3. Theme
- 2.4 4. Autostart
- 2.5 5. Information
- 2.6 6. Save

1. Main Window

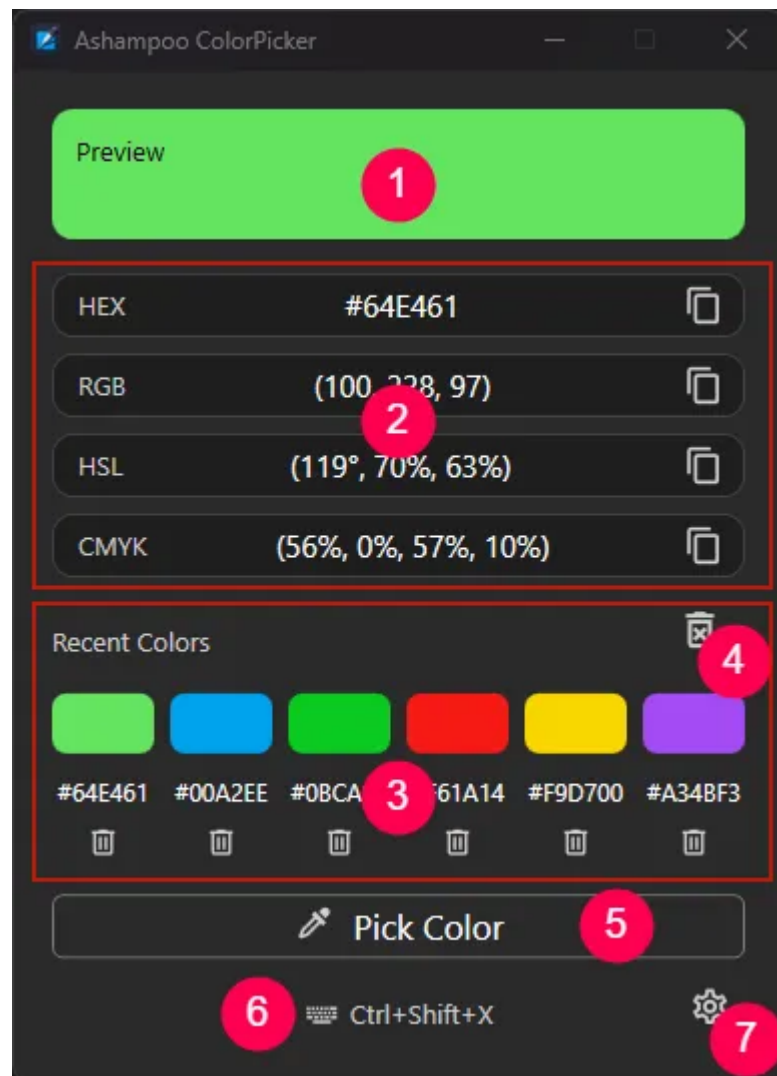

1.1 1. Preview

The most recently selected color is displayed here.

1.2 2. Color Values

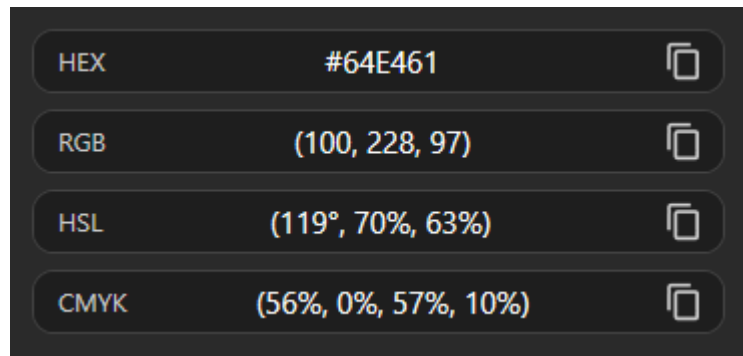

This section displays the four color values of the most recently selected color.

On the right side, you will find buttons that allow you to copy each value directly to the clipboard.

1.3 3. Color Palette

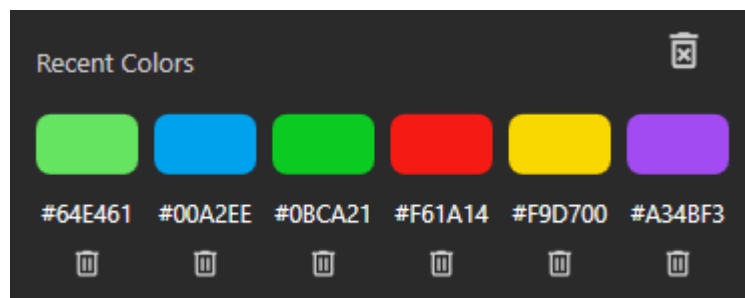

Here you can see the six most recently selected colors. The corresponding HEX value is displayed below each color for quick reference.

If you want to remove a specific color from the palette, use the delete button below that color.

1.4 4. Clear All Colors

This button removes all colors from your color palette.

This action cannot be undone.

1.5 5. Pick Color

Use this button to start the color picker and select a color from your screen.

1.6 6. Current Shortcut

The currently assigned keyboard shortcut for starting the color picker is displayed here.

1.7 7. Settings

This button opens the application settings.

| 2. Settings

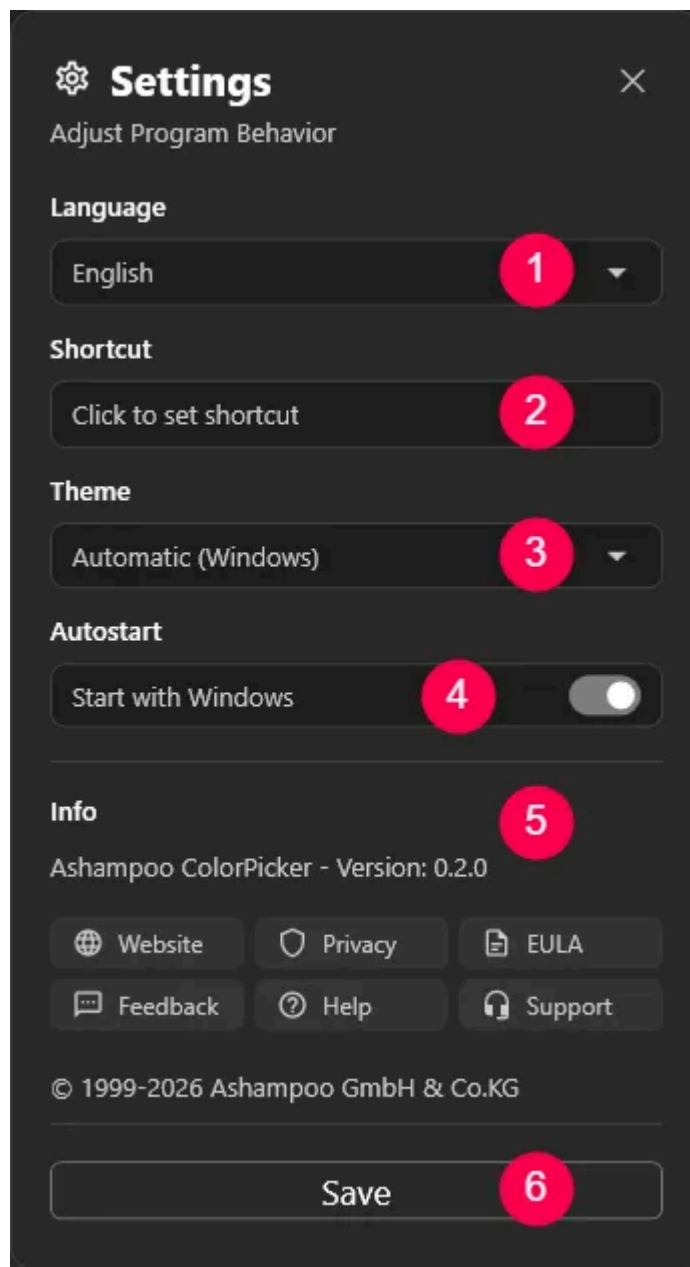

2.1 1. Language

Here you can select the language used by the application.

2.2 2. Shortcut

In this section, you can define a custom keyboard shortcut to quickly start the color picker.

2.3 3. Theme

Here you can choose between a light and dark theme or let the application follow your Windows appearance settings automatically.

2.4 4. Autostart

This option allows you to define whether the application should start automatically with Windows.

When Autostart is enabled, the application will start automatically after you sign in and run in the background within the taskbar notification area (system tray). The main window will not be opened or displayed automatically.

You can enable or disable this feature at any time using the toggle switch.

2.5 5. Information

This section displays general information about the application.

2.6 6. Save

Use this button to save all changes you have made.

If you close the settings without saving, all changes will be discarded.